

*Important: CHECK CHART BEFORE BORING ANY HOLES

*Template shown with S2002 or CS2002 Trim

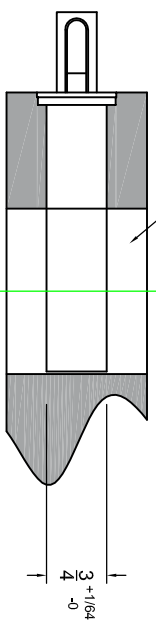

*Mount the trim with the screws provided, after the lock is installed and works properly.

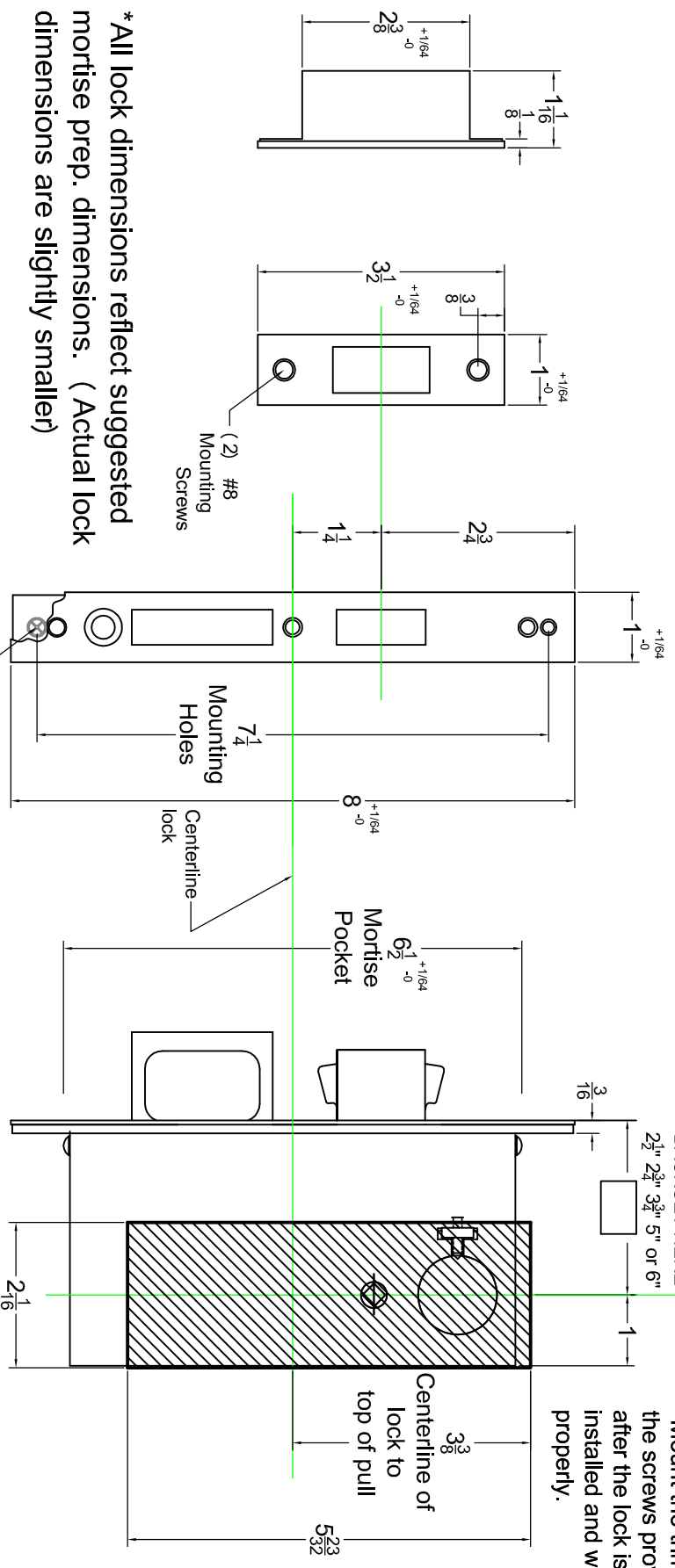

* All lock dimensions reflect suggested mortise prep. dimensions. (Actual lock dimensions are slightly smaller)

NOTE: S2002 Trim is Surface Mounted
 CS2002 Trim is Concealed Mounted
 Always pre-drill mounting holes

Template #2002S/CS

Accurate Lock and Hardware Co., LLC
 One Annie Place
 Stamford, CT 06902
 P (203) 348-8865 F (203) 348-5234
 Sales@accuratelockandhardware.com



Made in USA