

2000 Pocket Door Pull

Spring loaded edge pull

PUSH BUTTON
PROJECTS PULL (as shown)



CASE:

Heavy Gauge, Wrought
(11/16" thick)

PULL:

1/2" Thick—1 1/4" throw

ARMOR FRONT:

Wrought brass, bronze or
stainless steel.

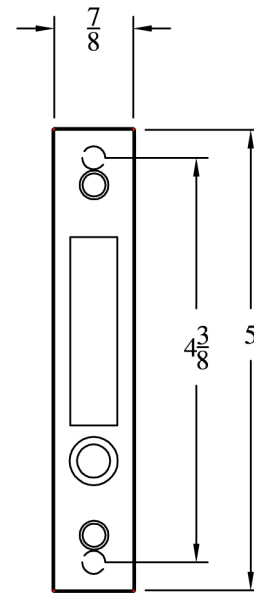
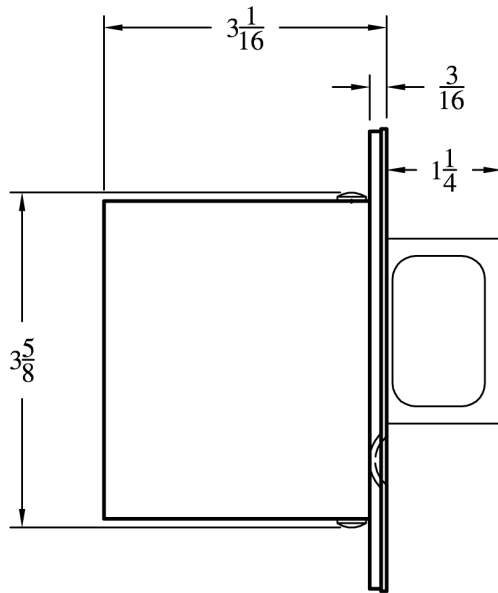

* Custom 1" wide armor front available

SUGGESTED TRIM FOR INSIDE AND OUTSIDE: A2002B, O2002B, N2002B, or S2002B

In addition to the above flush pulls (also available with concealed screws), please refer to our 24R and 24S flush cups for more trim options.